



Unit Illustrated: Model MQVLBG60NE2 Bay Peninsula Direct Vent Fireplace (Natural Gas), VLBGCK Corner Kit, MQG5C Glass Media (Bronze x3), MQVL60RGB Reflective Glass Liner (Back).
(Chase must be vented below and above appliance – consult manual for instructions).

 **marquis**
FIREPLACE COLLECTION

Enclave

Zero Clearance Direct Vent Gas Fireplace
(Single-Sided, See-Through, Bay Peninsula)

More options. More dimensions.

This beguiling fireplace from Marquis adapts to suit any room with options for a Single Side, See-Through, Corner or a Bay Peninsula. Plus, our new 61/62 Enclave is bigger and bolder with a larger Tall-Glass viewing area.

The choices don't stop there. The look of the Enclave transforms completely with your choice of fireplace liners and accessories that range from logs in driftwood, oak, and birch styles, as well as contemporary rocks, cannonballs, and glass media.

Plus with the Enclave's innovative vented chase technology you can clad the fireplace with combustible materials up to the glass door opening.

If the 'wow' factor gets you fired up, the Enclave is for you!



FIND
ALL DETAILED
ENCLAVE
MANUALS

Unit Illustrated:
Model MQVLBG60NE2 Bay Peninsula Direct Vent Fireplace (Natural Gas), MQG5C Ember Glass (Bronze x2), MQLOGF48D Log Set (Driftwood), MQSTONE10 Decorative Stones (10 pce), MQVL60RLSB Liner (Stacked Brick).

Features

Standard

- Accent Lighting:
Enclave 48/60/61/62/72 – LED Lighting (non-dimmable)
Enclave 34 – Halogen Lighting
- Invisible Glass Safety Barrier
- Proflame II Models include Remote Control with the following features:
flame adjustment, thermostat, smart thermostat (WIFI Compatibility*) and accent lighting control



* Smartphone (local WIFI only)

Optional

Surrounds:

Black or Stainless (Single Side or See-Through models only)

Liners:

Enclave 48/60/72 – Reflective Glass, Fluted Brick, and Stacked Brick

Enclave 61/62 – Reflective Glass, Fluted Brick

Enclave 34 – Reflective Glass, Fluted and Traditional Brick

Media Options (Required):

Glass Media (Glacier Ice, Cobalt Blue, Black, Bronze, White)

Additional Media (Optional):

Cannonballs, Decorative Stones, Contemporary Rocks, Ember Chunks

Log Sets:

Oak, Birch, and Driftwood Sets

Enclosure Grills:

Front or Sides – Unfinished

Corner Kit:

Available for Bay Peninsula Unit

Side Extension Panels:

Enclave 48/60/72 – Black; Single-Sided Models only

Wall Mount Battery Holder (WMBH):

The battery holder provides power to the IPI system in case of power failures. Locating the battery holder outside of the fireplace (wall mount), provides a convenient and accessible location for battery installation and removal.

Benefits of our Cool Wall Vented Chase Technology**

- Zero Clearances to TVs and Artwork
- Combustible materials may be used right up to the glass door opening
- No fans required to vent the chase, will work during power failures (batteries required)
- Seamless glass, removes the need for steel safety screen barrier
- Allows for all wood framing
- Allows for reduced mantel clearances

**This appliance is approved for use with 5"8" Kingsman Flex, M&G-Duravent Direct Vent system (Model DV-GS Series) and Snorkel, BDM Pro Form Direct Vent, Ameri-Vent Direct Vent Pipe System, ICC Excel Direct, Metal Fab Sure-Seal DV and Selkirk Direct Temp. When using ICC Excel Direct a one-foot section of 5"8" MG Duravent must be used as a starter collar at the flue of the appliance.



Unit Illustrated:

Model MQVLBG48NE2 Bay Peninsula Direct Vent Fireplace (Natural Gas), VL48EG Grill Kit for Enclosure, MQRBRW Birch Log Set, MQG5C Glass Media (Bronze x2), MQSTONE10 Decorative Stones, MQVL48RGB Reflective Glass Liner (Back).
(Chase must be vented below and above appliance. Consult manual for instructions).



Enclave 34

Unit Illustrated: Model MQZCVBG34NE2 Direct Vent Fireplace (Natural Gas), VL34EG Grill Kit for Enclosure, MQLOGF453 Driftwood Log Set, MQZCVBG34RGB Reflective Glass Liner (Back).

(Chase must be vented above appliance. Consult manual for instructions).

MODELS >	MQZCVBG34NE2	MQZCVBG34LPE2
Type	BAY PENINSULA	BAY PENINSULA
Fuel	Natural	Propane
Gas Control	IPI PF2	IPI PF2
Input Max.	25,000 BTU	24,000 BTU
Input Min.	17,500 BTU	19,000 BTU
Venting	5 ⁷ / ₈ "	5 ⁷ / ₈ "
Glass Size	33 ¹¹ / ₁₆ " W X 22" H	33 ¹¹ / ₁₆ " W X 22" H
Glass Type	Ceramic	Ceramic
FE (P.4.1-15)	52.94%	51.96%

THIS UNIT CAN BE CONVERTED TO A CORNER INSTALLATION





Unit Illustrated: Model MQZCVBG34NE2 Bay Peninsula Direct Vent Fireplace (Natural Gas), MQLOGF34BW Birch Log Set, and MQZCVBG34RGB Reflective Glass Liner (Back).

(Chase must be vented above appliance.
Consult manual for instructions).

Enclave 48

MODELS >	MQVLBG48NE2	MQVLBG48LPE2	MQVL48NE2	MQVL48LPE2
Type	BAY PENINSULA	BAY PENINSULA	SINGLE-SIDED	SINGE-SIDED
Fuel	Natural Gas	Propane	Natural Gas	Propane
Gas Control	IPI PF2	IPI PF2	IPI PF2	IPI PF2
Input Max.	35,000 BTU	35,000 BTU	35,000 BTU	35,000 BTU
Input Min.	25,000 BTU	27,000 BTU	25,000 BTU	27,000 BTU
Venting	5"8"	5"8"	5"8"	5"8"
Glass Size	49 1/6" W x 17 7/8" H	49 1/6" W x 17 7/8" H	49 1/6" W x 17 7/8" H	49 1/6" W x 17 7/8" H
Glass Type	Ceramic	Ceramic	Ceramic	Ceramic
FE (P.4.1-15)	53.20%	53.20%	53.20%	53.20%

Unit Illustrated: Model MQVLBG48NE2 Bay Peninsula Direct Vent Fireplace (Natural Gas), VLBGCK Corner Kit, MQG5C Glass Media (Bronze x1), MQSTONE Decorative Stones, MQVL48RGB Reflective Liner (Back) and MQVL72RGE Reflective Glass Liner (Ends).
(Chase must be vented below and above appliance. Consult manual for instructions).



THE FIREPLACE CHASE MUST BE VENTED BOTH ABOVE AND BELOW APPLIANCE*

ABOVE appliance: 151 sq./in. BELOW appliance: 84 sq./in.

**Consult Installation Manual for requirements and further clarification.*



Variations



MQVLBG48NE2 Bay Peninsula Direct Vent Fireplace (Natural Gas), VLBGCK Corner Kit, MQG5C Glass Media (Bronze x2), MQRBD3 Driftwood Log Set, MQSTONE10 Decorative Stones.



MQVLBG48NE2 Direct Vent Fireplace (Natural Gas), VLBGCK Corner Kit, MQG5C Glass Media (Bronze x2), MQ46D Driftwood Log Set, MQSTONE10 Decorative Stones, MQVL48RGB Reflective Glass Liner (Back).



MQVLBG48NE2 Direct Vent Fireplace (Natural Gas), MQG5C Glass Media (Bronze x2), MQVL48RLFB2 Fluted Brick Liner (Back)



MQVLBG48NE2 Direct Vent Fireplace (Natural Gas), MQG5C Glass Media (Bronze x2), MQLOAK1 Log Set (Oak), MQSTONE10 Decorative Stones, MQVL48RLFB2 Fluted Brick Liner (Back)

Unit Illustrated (right): Model MQVL48NE2 Direct Vent Fireplace (Natural Gas), VL48EG Grill Kit for Enclosure, MQG5C Glass Media (Bronze x2), MQRBD3 Driftwood Log Set, MQSTONE Decorative Stones. MQVL48RGB Reflective Glass Liner (Back), MQVL72RGE Reflective Glass Liner (Ends), MQVL48S1BL Surround (Black).

(Chase must be vented below and above appliance. Consult manual for instructions).



Enclave 60

MODELS >	MQVLBG60NE2	MQVLBG60LPE2	MQVL60NE2	MQVL60LPE2
Type	BAY PENINSULA	BAY PENINSULA	SINGLE-SIDED	SINGE-SIDED
Fuel	Natural Gas	Propane	Natural Gas	Propane
Gas Control	IPI PF2	IPI PF2	IPI PF2	IPI PF2
Input Max.	45,000 BTU	44,000 BTU	45,000 BTU	44,000 BTU
Input Min.	32,000 BTU	35,000 BTU	32,000 BTU	35,000 BTU
Venting	5" / 8"	5" / 8"	5" / 8"	5" / 8"
Glass Size	61 1/2" W x 17 7/8" H	61 1/2" W x 17 7/8" H	61 1/2" W x 17 7/8" H	61 1/2" W x 17 7/8" H
Glass Type	Ceramic	Ceramic	Ceramic	Ceramic
FE (P.4.1-15)	56.18%	56.52%	56.18%	56.52%

THE FIREPLACE CHASE MUST BE VENTED BOTH ABOVE AND BELOW APPLIANCE*

ABOVE appliance: 200 sq./in. BELOW appliance: 102 sq./in.

**Consult Installation Manual for requirements and further clarification.*

Unit Illustrated: MQVLBG60NE2 Bay Peninsula Direct Vent Fireplace (Natural Gas), VL60EG Grill Kit for Enclosure, MQG5C Ember Glass (Bronze x2), MQLOAK1 Log Set (Oak), MQLOAK2 Log Set (Oak), MQSTONE10 Decorative Stones (10 pce), MQVL60RSLB Liner (Stacked Brick).

(Chase must be vented below and above appliance. Consult manual for instructions).



Variations



MQVLBG60NE2 Bay Peninsula Direct Vent Fireplace (Natural Gas), MQG5C Ember Glass (Bronze x2), MQLOGF48D Log Set (Driftwood), MQSTONE10 Decorative Stones (10 pce), MQVL60RLSB Liner (Stacked Brick).



MQVLBG60NE2 Bay Peninsula Direct Vent Fireplace (Natural Gas), MQG5C Ember Glass (Bronze x3), MQVL60RBG Back Liner (Reflective Glass).



MQVLBG60NE2 Bay Peninsula Direct Vent Fireplace (Natural Gas), MQG5C Ember Glass (Bronze x2), MQRBD3 Log Set (Driftwood), MQSTONE10 Decorative Stones (10 pce), MQVL60RLSB Liner (Stacked Brick).



MQVL60NE2 Direct Vent Fireplace (Natural Gas), MQG5C Ember Glass (Bronze x2), RBCB1 Cannonballs, MQVL60RGB Back Liner (Reflective Glass), MQVL72RGE End Liner (Reflective Glass).



Unit Illustrated: Model MQVL60NE2 Direct Vent Fireplace (Natural Gas), MQG5C Ember Glass (Bronze x3), MQVL60RBG Back Liner (Reflective Glass).

(Chase must be vented below and above appliance. Consult manual for instructions.)

Enclave 61

Unit Illustrated: MQV6L1NE2 Direct Vent Fireplace (Natural Gas), MQG5C Ember Glass (Bronze x2), MQ42LOG3 Log Set (Driftwood), MQSTONE10 Decorative Stones (10 pce), MQVL61RGB Reflective Glass Liner (Back), MQVL61RGE Reflective Glass Liner (Ends).

(Chase must be vented below and above appliance. Consult manual for instructions).

MODELS >	MQVL61NE2	MQVL61LPE2
Type	SINGLE-SIDED	SINGLE-SIDED
Fuel	Natural Gas	Propane
Gas Control	IPI PF2	IPI PF2
Input Max.	45,000 BTU	44,000 BTU
Input Min.	29,000 BTU	34,000 BTU
Venting	5/8"	5/8"
Glass Size	61 7/16" W x 21 5/16" H	61 7/16" W x 21 5/16" H
Glass Type	Ceramic	Ceramic
FE (P.4.1-15)	60.10%	64.08%

THE FIREPLACE CHASE MUST BE VENTED BOTH ABOVE AND BELOW APPLIANCE*

ABOVE appliance: 220 sq./in. BELOW appliance: 100 sq./in.

**When venting below the appliance, this can be right below the fireplace (with a floating hearth) or at the bottom of the base. Consult Installation Manual for requirements and further clarification.*



Enclave 61 Variations

F7 PRO BURNER

LINEAR FLAME PATTERN (MQVL6162BF7 – DEALER INSTALLED)



MQVL61NE2 Direct Vent Fireplace (Natural Gas), MQG5C Ember Glass (Bronze x2), MQRBRW Log Set (Birch), MQSTONE10 Decorative Stones (10 pce), MQVL61RBG Back Liner (Reflective Glass), MQVL61RGE End Liner (Reflective Glass), MQVL6162BF7 Pro-Burner F7 (Linear Flame Pattern).

F3 PRO BURNER

TRI-FLAME (FACTORY INSTALLED)



MQVL61NE2 Direct Vent Fireplace (Natural Gas), MQG5C Ember Glass (Bronze x2), MQRBD3/MQRBD4 Log Sets (Driftwood), MQSTONE10 Decorative Stones (10 pce), MQVL61RBG Back Liner (Reflective Glass).

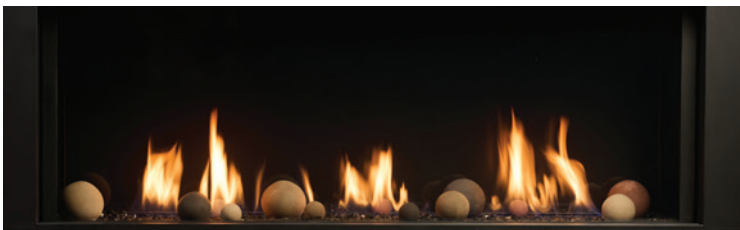

MQVL61NE2 Direct Vent Fireplace (Natural Gas), MQG5C Ember Glass (Bronze x2), RBCB1 Cannonballs, MQVL61RBG Reflective Glass Liner (Back), MQVL61RGE Reflective Glass Liner (Ends).

Unit Illustrated:

MQVL61NE2 Direct Vent Fireplace (Natural Gas), MQG5C Ember Glass (Bronze x2), MQLOAK1/MQLOAK2 Log Sets (Oak), MQSTONE10 Decorative Stones (10 pce), VL61S1BL Surround (Black), MQVL61RBG Reflective Glass Liner (Back), MQVL61RGE Reflective Glass Liner (Ends).
(Chase must be vented below and above appliance. Consult manual for instructions).



Enclave 62

MODELS >	MQVLST62NE2	MQVLST62LPE2
Type	SEE-THROUGH	SEE-THROUGH
Fuel	Natural Gas	Propane
Gas Control	IPI PF2	IPI PF2
Input Max.	45,000 BTU	44,000 BTU
Input Min.	29,000 BTU	34,000 BTU
Venting	5/8"	5/8"
Glass Size	61 7/16" W x 21 5/16" H	61 7/16" W x 21 5/16" H
Glass Type	Ceramic	Ceramic
FE (P.4.1-15)	62.57%	65.36%

THE FIREPLACE CHASE MUST BE VENTED BOTH ABOVE AND BELOW APPLIANCE*

ABOVE appliance: 220 sq./in. BELOW appliance: 100 sq./in.

**When venting below the appliance, this can be right below the fireplace (with a floating hearth) or at the bottom of the base. Consult Installation Manual for requirements and further clarification.*

Unit Illustrated: MQVLST62NE2 Direct Vent Fireplace (Natural Gas), MQ42LOG1 Log Set (Driftwood), MQG5C Ember Glass (Bronze x2), VL60EGS Grill (side).

(Chase must be vented below and above appliance. Consult manual for instructions).



Enclave 62 Variations

SEE-THROUGH



MQVLST62NE2 Direct Vent Fireplace (Natural Gas), MQRBD3/MQRBD4 Log Sets (Driftwood), MQG5C Ember Glass (Bronze x2), MQSTONE10 Decorative Stones (10 pce).



MQVLST62NE2 Direct Vent Fireplace (Natural Gas), M42LOG3 Log Set (Oak), MQG5C Ember Glass (Bronze x2), MQSTONE10 Decorative Stones (10 pce).



Unit Illustrated: MQVLST62NE2 Direct Vent Fireplace (Natural Gas), MQRBRW Log Set (Birch), MQG5C Ember Glass (Bronze x2), MQSTONE10 Decorative Stones (10 pce), MQVL60S1BL Surround (Black). (Chase must be vented below and above appliance. Consult manual for instructions).

Burner Comparison

F7 PRO BURNER

LINEAR FLAME PATTERN (MQVL6162BF7 – DEALER INSTALLED)



MQVLST62NE2 Direct Vent Fireplace (Natural Gas), MQG5C Ember Glass (Bronze x2), MQRBD3/MQRBD4 Log Sets (Driftwood), MQSTONE10 Decorative Stones (10 pce), MQVL6162BF7 Pro Burner F7 (Linear Flame Pattern).

F3 PRO BURNER

TRI-FLAME (FACTORY INSTALLED)



MQVLST62NE2 Direct Vent Fireplace (Natural Gas), MQG5C Ember Glass (Bronze x2), MQLOAK1/MQLOAK2 Log Sets (Oak), MQSTONE10 Decorative Stones (10 pce), VL61S1BL Surround (Black).

Enclave 72

MODELS >	MQVLBG72NE2	MQVLBG72LPE2	MQVL72NE2	MQVL72LPE2
Type	BAY PENINSULA	BAY PENINSULA	SINGLE-SIDED	SINGE-SIDED
Fuel	Natural Gas	Propane	Natural Gas	Propane
Gas Control	IPI PF2	IPI PF2	IPI PF2	IPI PF2
Input Max.	50,000 BTU	50,000 BTU	50,000 BTU	50,000 BTU
Input Min.	34,000 BTU	39,000 BTU	34,000 BTU	39,000 BTU
Venting	5"8"	5"8"	5"8"	5"8"
Glass Size	73 1/6" W x 17 7/8" H	73 1/6" W x 17 7/8" H	73 1/6" W x 17 7/8" H	73 1/6" W x 17 7/8" H
Glass Type	Ceramic	Ceramic	Ceramic	Ceramic
FE (P.4.1-15)	60.32%	60.32%	60.32%	60.32%

THE FIREPLACE CHASE MUST BE VENTED BOTH ABOVE AND BELOW APPLIANCE*
 ABOVE appliance: 285 sq./in. BELOW appliance: 158 sq./in.

**Consult Installation Manual for requirements and further clarification.*

Unit Illustrated: Model MQVLBG72NE2 Bay Peninsula Direct Vent Fireplace (Natural Gas), MQG5W Ember Glass (White x2), MQLOGF48D Log Set (Driftwood), MQSTONE10 Decorative Stones (10 pce), MQVL72RGB Back Liner (Reflective Glass).
 (Chase must be vented below and above appliance. Consult manual for instructions).



Variations



MQVLBG72NE2 Bay Peninsula Direct Vent Fireplace (Natural Gas), MQG5W Ember Glass (White x3), MQVL72RGB Back Liner (Reflective Glass).



MQVL72NE2 Single Side Direct Vent Fireplace (Natural Gas), MQG5A Ember Glass (Cobalt x3), MQVL72RGB Back Liner (Reflective Glass).



MQVLBG72NE2 Bay Peninsula Direct Vent Fireplace (Natural Gas), MQG5C Ember Glass (Bronze x2), MQLOGF48D Log Set (Driftwood), MQSTONE10 Decorative Stones (10 pce), MQVL72RGB Back Liner (Reflective Glass).



Unit Illustrated (right): Model MQVL72NE2 Direct Vent Fireplace (Natural Gas), MQG5A Ember Glass (Cobalt x3), VL72S1SS Surround (Stainless Steel), MQVL72RGB Back Liner (Reflective Glass). Shown with Optional VL72EG Grill (Front Enclosure).

(Chase must be vented below and above appliance. Consult manual for instructions).



Specifications

DIMENSIONS

MQVLBG34 BAY PENINSULA

A	16 7/16"
B	34 5/16"
C	37 5/8"
D	34 5/8"
E	34 1/8"
F	21 1/2"
G	7 9/16"
H	20 15/16"
I	9/16"
J	3 1/2"
K	5 1/16"
L	4 7/16"
M	16 3/4"
N	37 5/8"
O	—
P	14 13/32"

MQVL48 SINGLE-SIDED

A	18 13/16"
B	56 1/2"
C	36 5/16"
D	46 3/8"
E	54 15/16"
F	49 1/16"
G	9 3/4"
H	15 1/4"
I	9/16"
J	4"
K	7 5/16"
L	4 9/16"
M	18"
N	36 1/4"
O	8 1/4"
P	—

MQVLBG48 BAY PENINSULA

A	18 13/16"
B	56 1/2"
C	36 5/16"
D	46 3/8"
E	54 15/16"
F	49 1/16"
G	9 3/4"
H	15 1/4"
I	—
J	4"
K	7 1/4"
L	4 9/16"
M	18"
N	36 1/4"
O	8 1/4"
P	14 13/32"

MQVL60 SINGLE-SIDED

A	20 1/16"
B	68 1/2"
C	36 5/16"
D	58 1/2"
E	66 1 1/16"
F	61 1/32"
G	9 3/4"
H	15 1/4"
I	1 1/16"
J	4"
K	7 5/16"
L	4 9/16"
M	18"
N	36 5/16"
O	8 1/4"
P	—

MQVLBG60 BAY PENINSULA

A	20 1/16"
B	68 1/2"
C	36 5/16"
D	58 1/2"
E	66 5/8"
F	61 1/32"
G	9 3/4"
H	15 1/4"
I	3/4"
J	4"
K	7 5/16"
L	4 9/16"
M	18"
N	36 5/16"
O	8 1/4"
P	14 13/32"

MQVL61 SINGLE-SIDED

A	19 7/16"
B	72 5/8"
C	44 1/2"
D	61"
E	—
F	61 7/16"
G	10 1/8"
H	21 5/16"
I	—
J	—
K	6 7/16"
L	4 3/8"
M	—
N	—
O	—
P	—

MQVLST62 SEE-THROUGH

A	19 13/16"
B	72 5/8"
C	41 13/16"
D	61"
E	—
F	61 7/16"
G	10 1/8"
H	21 5/16"
I	—
J	—
K	6 3/8"
L	4 3/8"
M	—
N	—
O	—
P	—

MQVL72 SINGLE-SIDED

A	18 13/16"
B	80 1/2"
C	36 5/16"
D	70 1/2"
E	78 5/8"
F	73 3/16"
G	9 3/4"
H	15 1/4"
I	1 1/16"
J	4"
K	7 5/8"
L	4 9/16"
M	18 7/8"
N	36 5/16"
O	8 1/4"
P	—

MQVLBG72 BAY PENINSULA

A	18 7/8"
B	80 1/2"
C	36 5/16"
D	70 1/2"
E	78 5/8"
F	73 3/16"
G	9 3/4"
H	15 1/4"
I	3/4"
J	4"
K	7 5/16"
L	4 9/16"
M	18 7/8"
N	36 5/16"
O	8 1/4"
P	14 13/32"

FRONT VIEW

MQZCVBG34

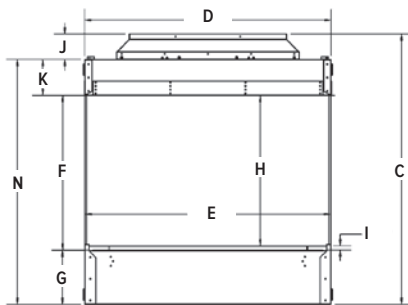

MQVL48/VLBG48, MQVL60/VLBG60, MQVL61/VLST62, MQVL72/VLBG72

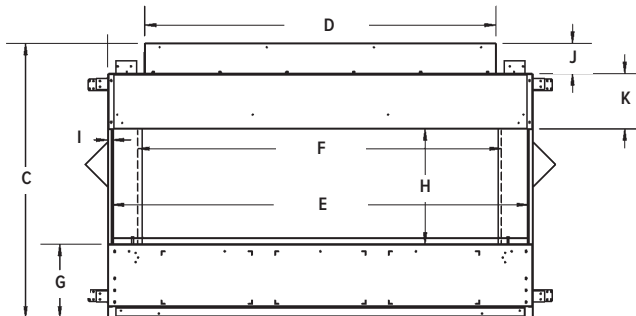

SIDE VIEW

SINGLE-SIDED

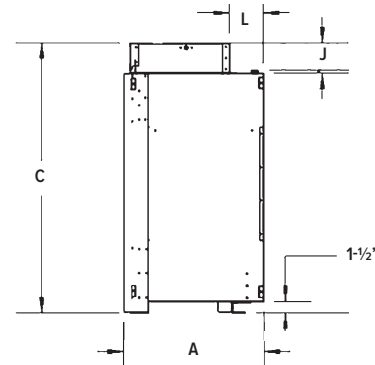

BAY PENINSULA

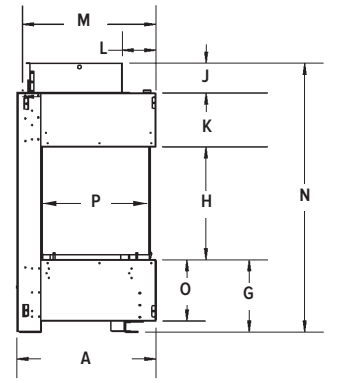

TOP VIEW

MQZCVBG34

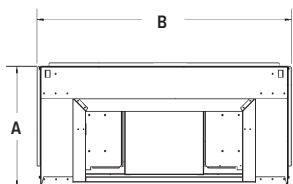

MQVL48/VLBG48, MQVL60/VLBG60, MQVL72/VLBG72

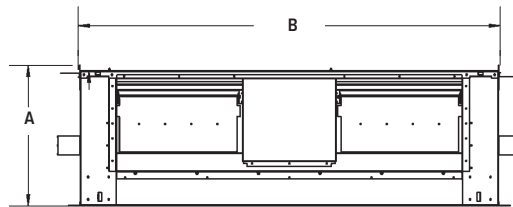

MQVL61/VLST62

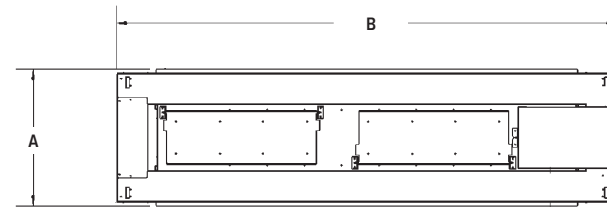

ENCLOSURE GRILLS

FRONT/TOP VIEW

VL34EG

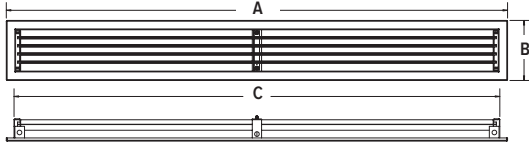

VL48EG

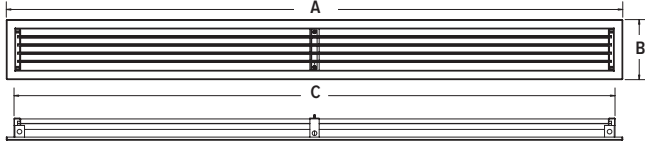

VL60EG/VL72EG

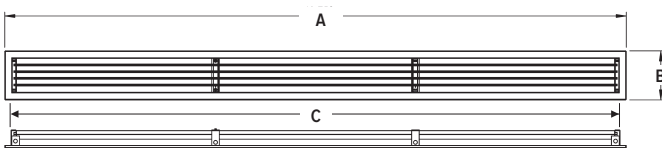

SIDE VIEW

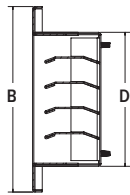

	VL34EG	VL48EG	VL60EG	VL72EG
A	32 5/16"	49 3/4"	61 3/4"	79 3/4"
B	4 3/8"	4 13/16"	4 7/8"	4 7/8"
C	31 3/16"	48 1/2"	60 1/2"	78 5/8"
D	3 1/4"	3 1/2"	3 5/8"	3 5/8"

CORNER KIT

BAY PENINSULA – ZCV34BGCK (34")

BAY PENINSULA – VLBGCK (48", 60", 72")

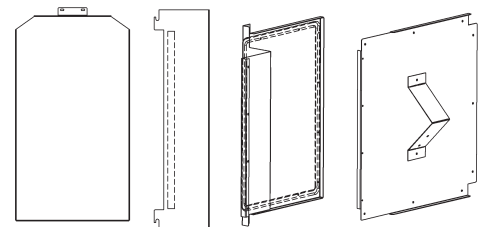

SIDE ENCLOSURE GRILL (PAIR)

FRONT VIEW

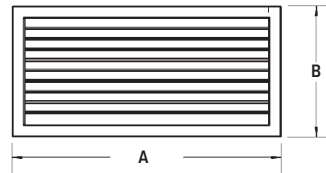

SIDE VIEW

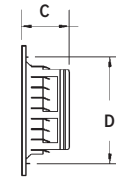

TOP VIEW



VL34EGS VL60EGS VL72EGS

A	11 1/4"	16 3/16"	16 3/16"
B	6"	7 7/8"	10 3/8"
C	2 5/8"	2 7/8"	2 7/8"
D	4 9/16"	6 7/16"	8 15/16"
E	10 1/2"	15 7/16"	15 7/16"
F	2 7/8"	2 9/16"	2 7/8"

WALL SURROUND

FRONT VIEW

SINGLE-SIDED/SEE-THROUGH

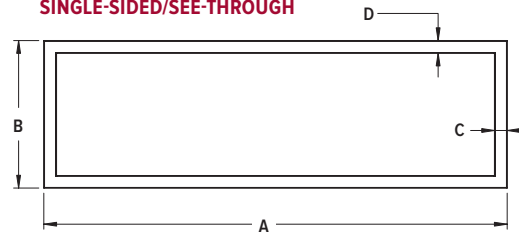

VL48S1 VL60S1 VL72S1 VL61

A	58 1/16"	70 1/16"	82 1/16"	65 7/16"
B	18 1/2"	18 1/2"	18 1/2"	25 1/8"
C	1 1/2"	1 1/2"	1 1/2"	2 1/8"
D	1 1/2"	1 1/2"	1 1/2"	2 1/8"

Adjustable Vented Platforms

Save on framing and adjust platform to your required height. Height is variable from 15" to 27". Ventilation slots are provided at the bottom and between the fireplace and the platform.

Note: the fireplace chase must be vented both above and below appliance, no fans are required.

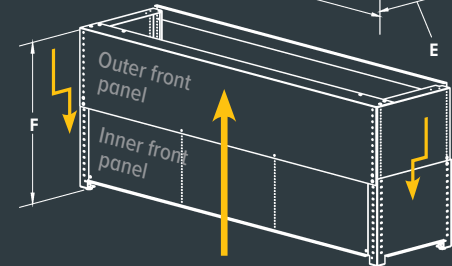
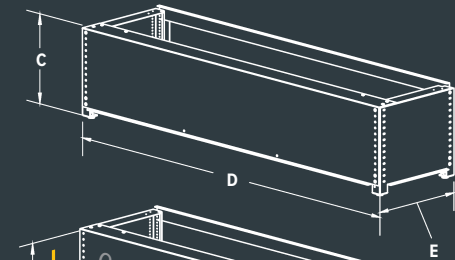
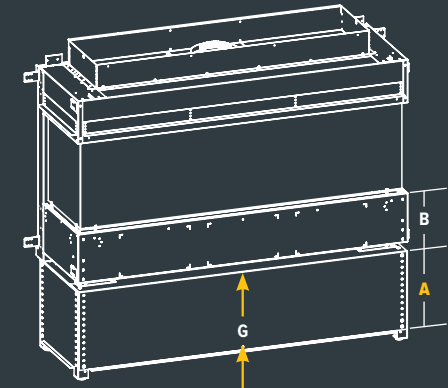

VL48AVP

A 15" to 27"

B 9 3/4"

C 15"

D 56"

E 17 1/8"

F 27"

G 84-85 sq.in.

VL60AVP

A 15" to 27"

B 9 3/4"

C 15"

D 68"

E 17 1/8"

F 27"

G 102-105 sq.in.

VL72AVP

A 15" to 27"

B 9 3/4"

C 15"

D 80"

E 17 1/8"

F 27"

G 160-162 sq.in.

Accessories

LOG SETS



MQLOGF340AK (7-Piece) Oak Set
ENCLAVE 34



MQLOAK1 Oak Set (Main Set)
ENCLAVE 48 / 60 / 61 / 62 / 72



MQLOAK1 and MQLOAK2 Oak Set (Add-On Set)
ENCLAVE 60 / 61 / 62 / 72



MQLOGF34BW (7-Piece) Birch Set
ENCLAVE 34



MQ46D (3-Piece) Driftwood Set
ENCLAVE 48 / 60 / 61 / 72



MQRBD3 (5-Piece) / MQRBD4 (3-Piece) Driftwood Set
ENCLAVE 34 / 48 / 60 / 61 / 62 / 72



MQ42D (6-Piece) Driftwood Set
ENCLAVE 34



MQLOGF48D (6-Piece) Driftwood Set
ENCLAVE 48 / 60 / 72



MQRBRW (5-Piece) Birch Set
ENCLAVE 48 / 60 / 61 / 62 / 72



MQLOGF453 (5-Piece) Driftwood Set
ENCLAVE 34



M42LOG3 Driftwood Set
ENCLAVE 61 / 62



MQ42LOG1 Driftwood Set
ENCLAVE 61 / 62

ROCK AND GLASS SETS



MQG5ZG Zircon Glacier Ice Glass



MQG5A Cobalt Ember Glass



MQG5B Black Ember Glass



MQG5C Bronze Ember Glass



MQG5W White Ember Glass



MQEMBER Ember Chunks



MQSTONE Decorative Stones



MQROCK2 Natural Rock Set



RBCB1 Multi-Colored Cannonballs

LINERS



Traditional Brick

ENCLAVE 34



Fluted

ENCLAVE 34 / 48 / 60 / 61 / 62 / 72



Stacked Brick

ENCLAVE 48 / 60 / 72

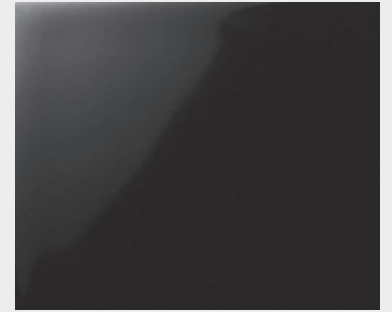

Glass Reflective

ENCLAVE 34 / 48 / 60 / 61 / 62 / 72



FOR CALIFORNIA RESIDENTS ONLY:

WARNING! This product can expose you to chemicals including Carbon Monoxide, that is an externally vented by-product of fuel consumption, which is [are] known to the State of California to cause birth defects or other reproductive harm. For more information, visit www.P65Warnings.ca.gov.



Marquis Fireplaces maintains a program of continuous testing, refinement and improvements of all its products. Some aspect of units shown here may be changed at any time without notice or obligation.

Certification: Certified to ANSI Z21.88-2017, CSA 2.33-2017 Vented Gas Fireplace Heaters.

Note: Components may have to be ordered separately to create a complete unit. Discuss with your local Marquis Dealer for clarification.

Canada

ENERGUIDE

Look for the **EnerGuide** Gas Fireplace Energy Efficiency Rating in this brochure

Based on CSA P.4.1-15



Unit Illustrated:

Model MQVLBG48NE2 Bay Peninsula Direct Vent Fireplace (Natural Gas), VL48EG Grill Kit for Enclosure, MQG5C Ember Glass (Bronze x2), MQRBRW Log Set (Birch), MQSTONE10 Decorative Stones (10 pce), MQVL48RGB Back Liner (Reflective Glass).

(Chase must be vented below and above appliance. Consult manual for instructions).



Crafted entirely in Canada, each Marquis fireplace is built to the highest standards and made to last.

LIMITED LIFETIME WARRANTY

2340 Logan Avenue
Winnipeg, Manitoba, CAN
R2R 2V3
Phone: 204.632.1962
Fax: 204.632.1960
marquisfireplaces.net

Printed in Canada
B100 - 06/2026